

PARTS LIST

Remote Engine Starter Unit Kit P/N 08E91-E54-100

Transmitter

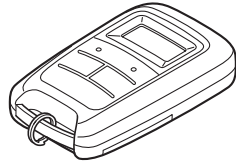

Control unit

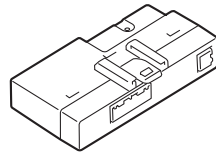

Antenna

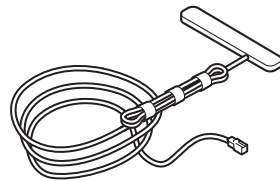

ID label

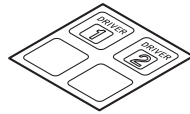

Remote Control Engine Starter Attachment Kit P/N 08E92-T3V-100

Engine starter harness

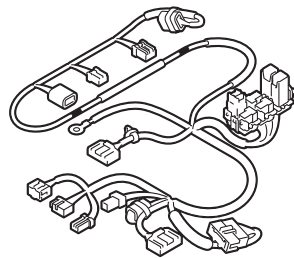

Control unit bracket



Relay bracket



3 Relays

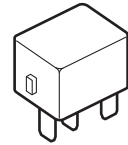

6 mm Flange nut



8 mm Flange nut



17 Wire ties

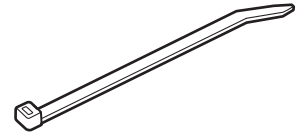

Wire tie with clip

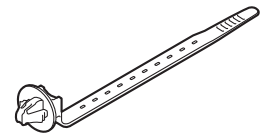

7 Urethane tapes

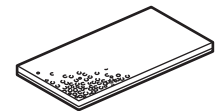

Clip

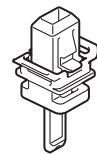

Caution label



Fuse label

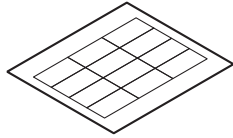

Accessory User's Information Manual

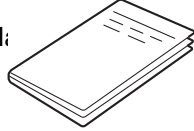

Quick Start Guide

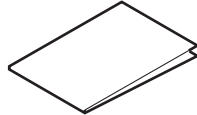

TOOLS AND SUPPLIES REQUIRED

- Flat-tip screwdriver
- Phillips screwdriver
- Ratchet
- 10 mm Socket
- 10 mm Open end wrench
- Isopropyl alcohol
- Shop towel
- Tape measure
- Scissors
- HDS/MVCI
- Masking tape
- Diagonal cutters
- Ruler
- Tape
- Utility knife

The following tools are available through the Honda Tool and Equipment Program. On the iN, click on: Service > Service Bay > Tool and Equipment Program, then enter the number under "Search". Or, call 888-424-6857.

- Trim Tool Set (T/N SOJATP2014)
- Plastic Trim Tool (T/N SILTRIMTL10)

Illustration of the Remote Control Engine Starter on the Vehicle

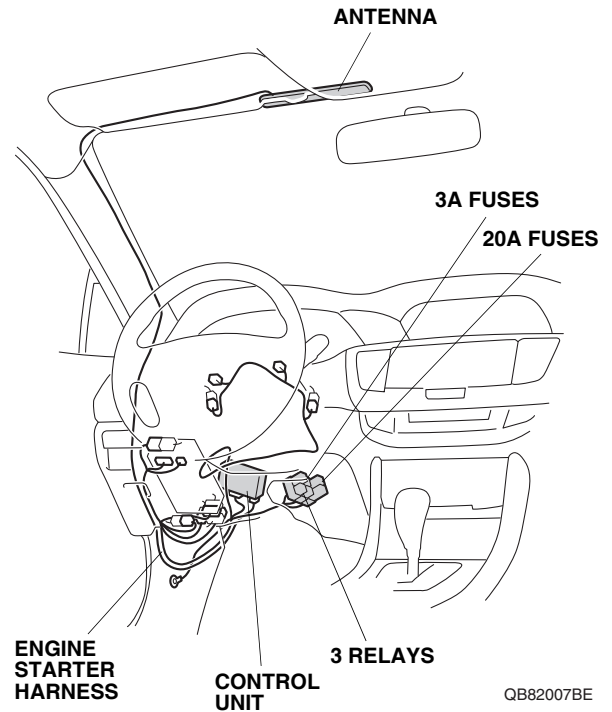

INSTALLATION

Customer Information: The information in this installation instruction is intended for use only by skilled technicians who have the proper tools, equipment, and training to correctly and safely add equipment to your vehicle. These procedures should not be attempted by “do-it-yourselfers.”

1. Disconnect the negative cable from the battery.
2. Attach the ID label.
 - Using isopropyl alcohol on a shop towel, clean the area where the ID label will attach.
 - Attach the ID label to the transmitter in the area as shown.

With Driving Position Memory System

NOTE: The remote is factory set for driver 1 remote control. To program the driver 2 remote, follow the “Register New Transmitter” instructions on ISIS.

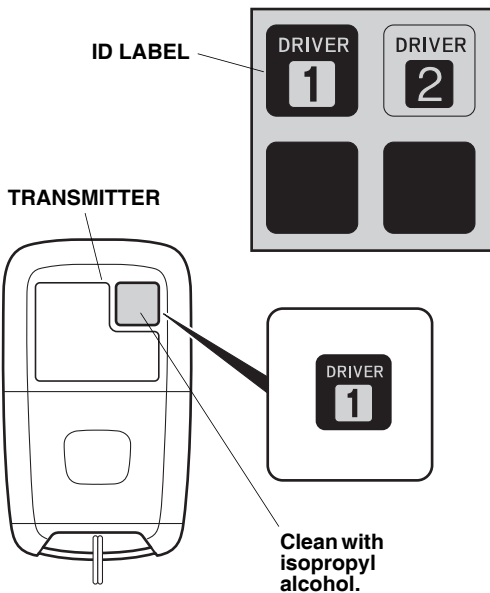

QB20939DH

Without Driving Position Memory System

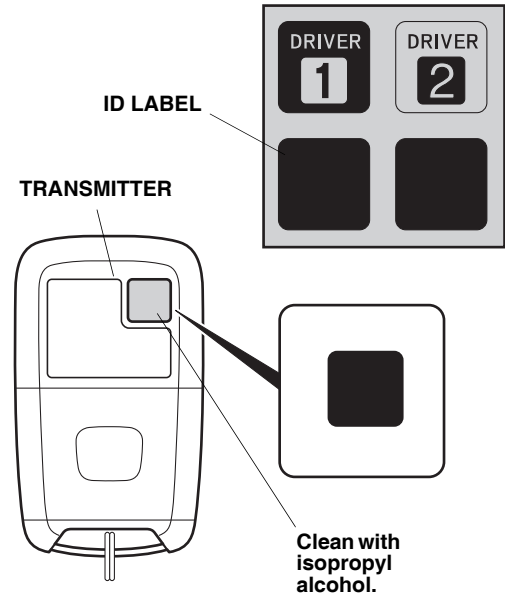

QB32111CH

3. If equipped, remove the roof console.
 - Using a plastic trim tool, pry out and remove the left and right lenses (four retaining tabs each).
 - Open the sunglass holder. Remove four screws.
 - Remove the roof console (unplug the vehicle connectors).

With Moonroof

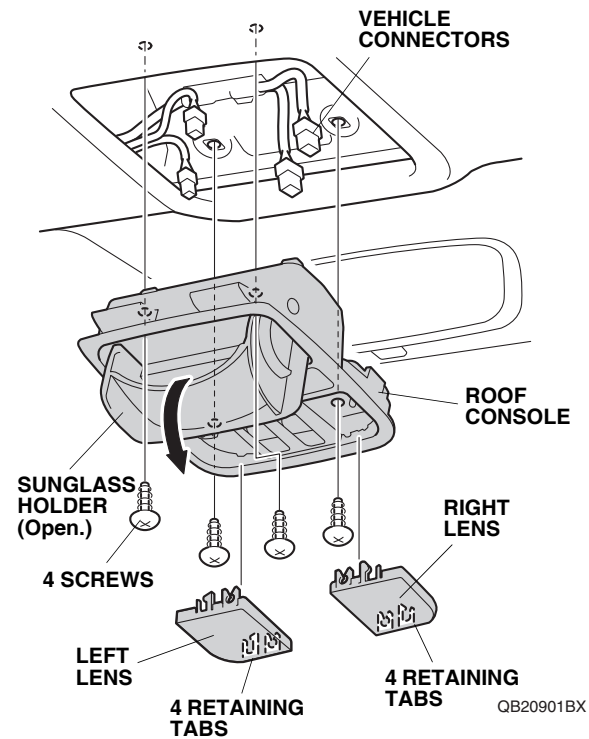

QB20901BX

Without Moonroof

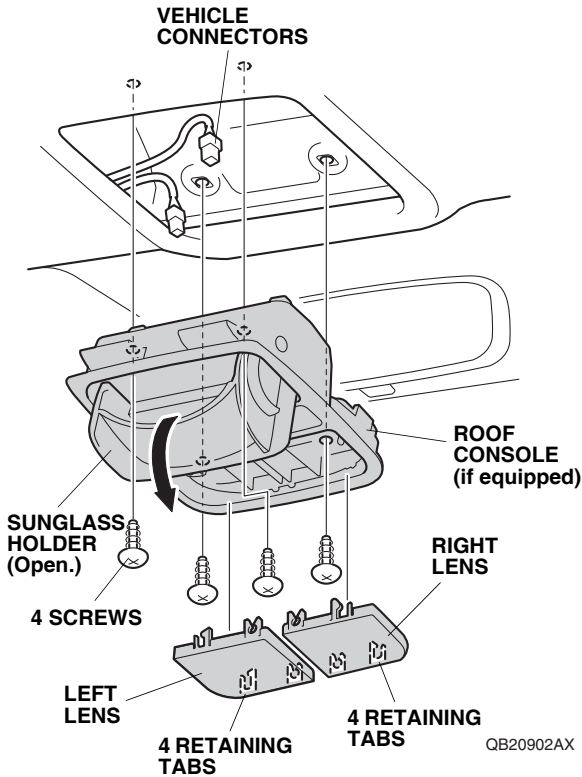

- Remove two sunvisor holders by rotating them 90° counterclockwise.

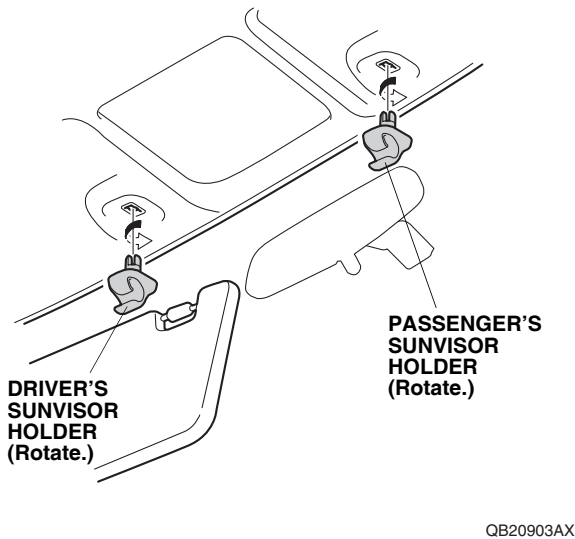

- Wrap the end of a flat-tip screwdriver with tape. Locate the slot in the bracket cover, and insert the flat-tip screwdriver into the slot. Push the hook with the screwdriver.

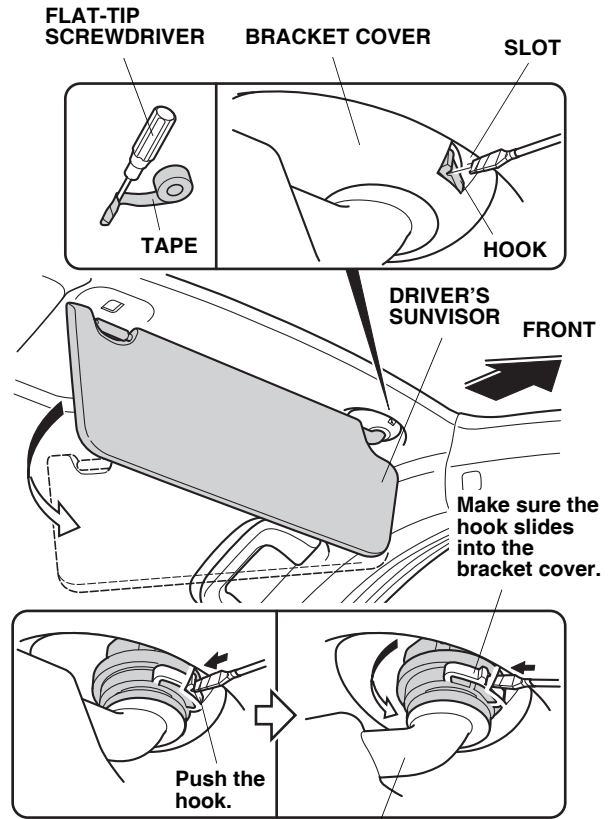

While pushing in on the hook, rotate the sunvisor backward about 45°. QB32101AX

- While pushing in on the hook, rotate the driver's sunvisor backward about 45°. Make sure the hook slides into the bracket cover. NOTE: If the hook did not stay pushed in, return the driver's sunvisor to its original position and repeat steps 5 and 6.

- Remove the driver's sunvisor (unplug the vehicle connector).

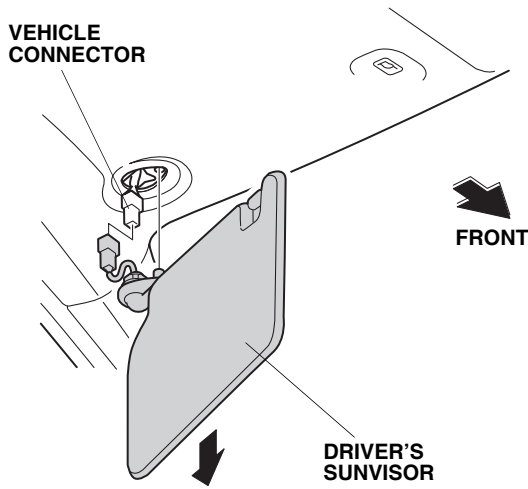

QB20904AX

- Pull away the driver's door opening seal in the area shown.

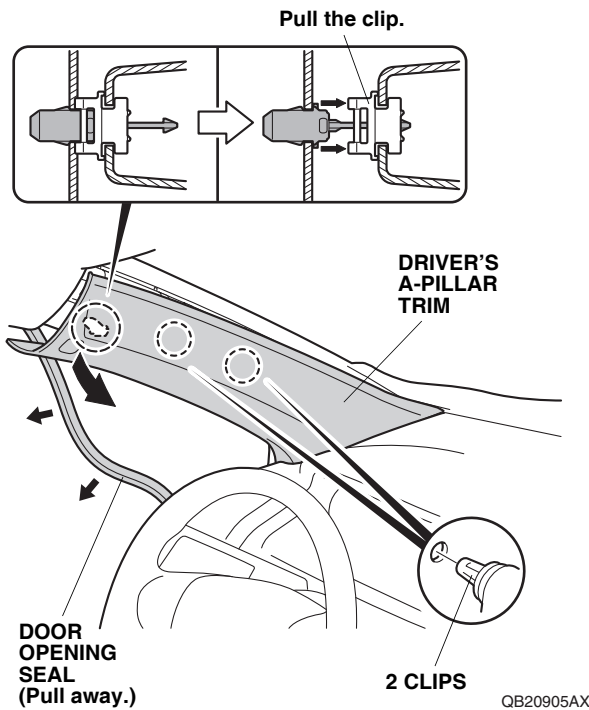

QB20905AX

- Pull out on the driver's A-pillar trim to release the clips.

- Insert a shop towel in the opening between the driver's A-pillar trim and the dashboard to prevent dropping the A-pillar clips. Take care not to damage the driver's A-pillar trim.

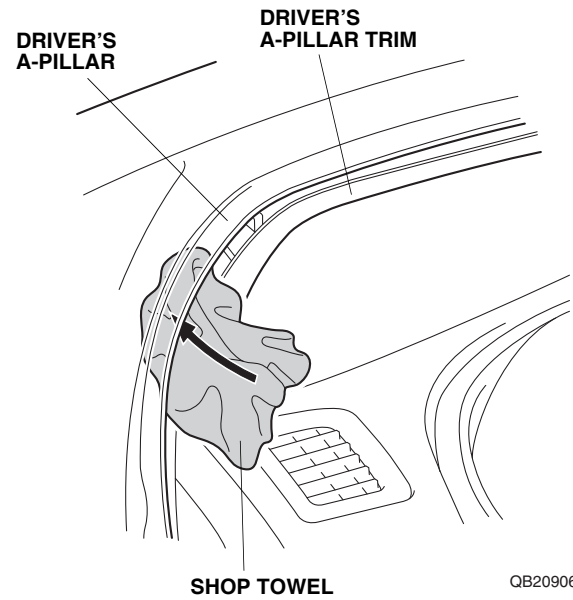

QB20906AX

- Slide up the driver's A-pillar trim to remove it from the upper clip. Carefully remove the shop towel and any clips that fell from the driver's A-pillar trim. **NOTE:** The upper clip will stay in the body.

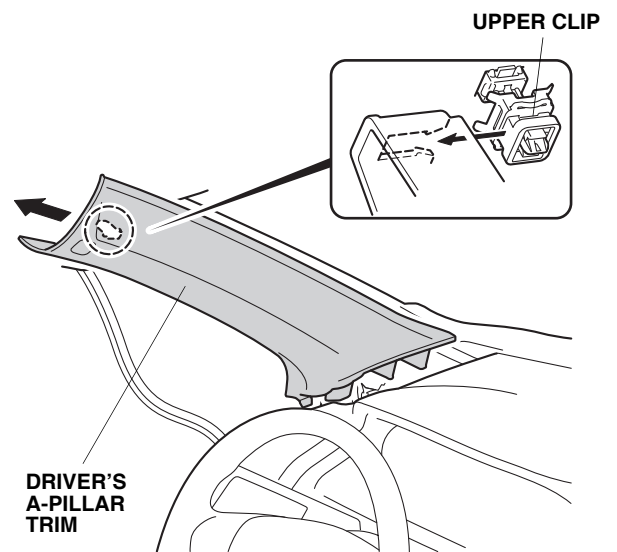

QB20907AX

12. Remove the remaining upper clip from the driver's A-pillar.

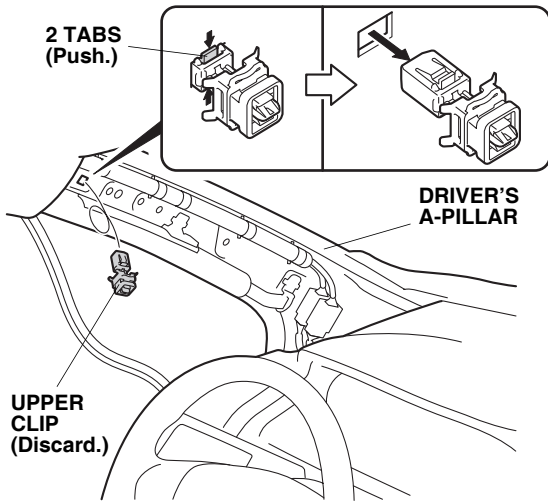

QB20908AX

13. Temporarily reinstall the driver's A-pillar trim, and check the overlap between the headliner and the driver's A-pillar trim according to the service manual. Remove the driver's A-pillar trim. Install the new clip (supplied) to the driver's A-pillar trim, but do not reinstall the trim at this time.

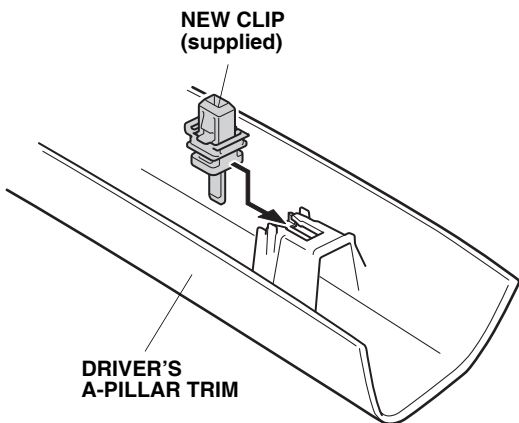

Q0N0533AH

14. Remove the driver's dashboard under cover (turn the knob and two clips).

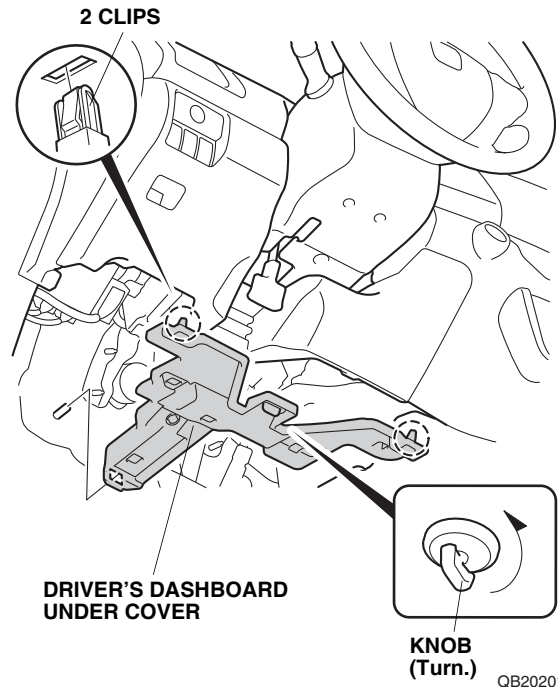

QB20201AB

15. Remove the driver's dashboard lower cover (nine clips and unplug the vehicle connectors, if equipped).

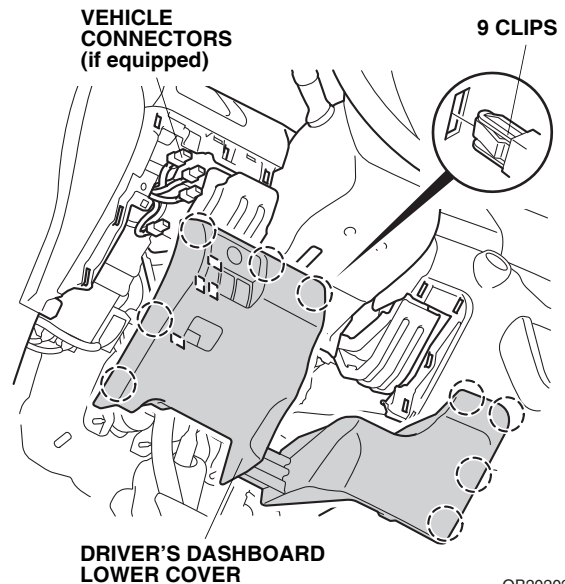

QB20202BB

16. Remove the cover (six retaining tabs).

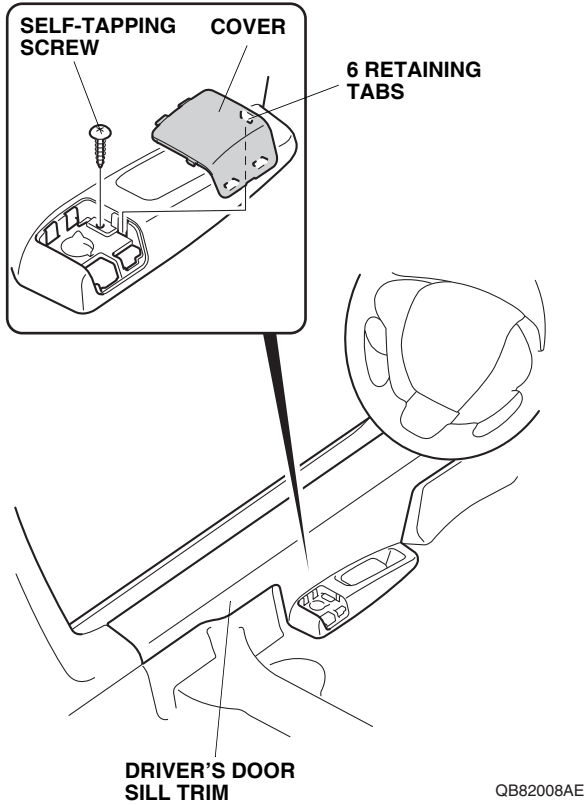

17. Remove one self-tapping screw from the driver's door sill trim.
18. Remove the driver's door sill trim (two retaining tabs and four clips).

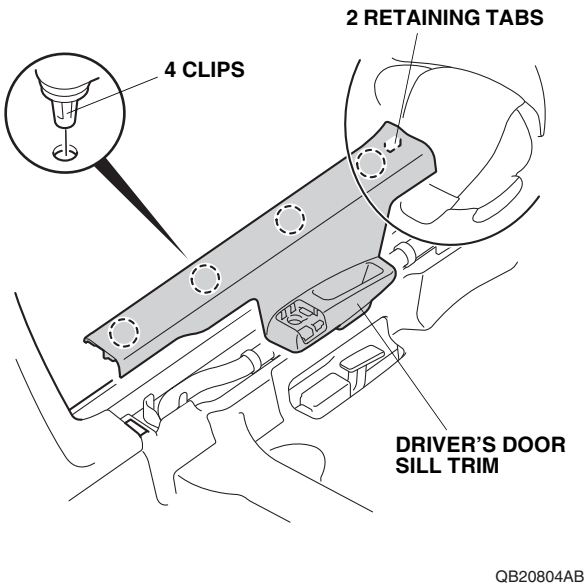

19. Pull away the door opening seal, and remove the driver's kick panel (two clips).

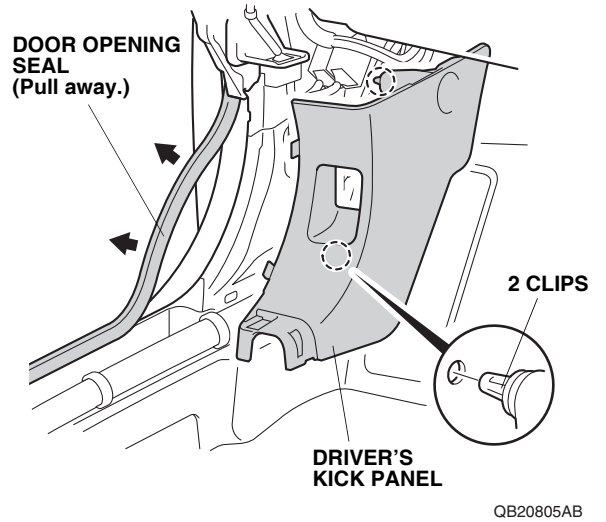

20. Lower the tilt lever, and release the column band (two clips). Reconnect the negative cable to the battery, then press the power switch to select the ON mode.

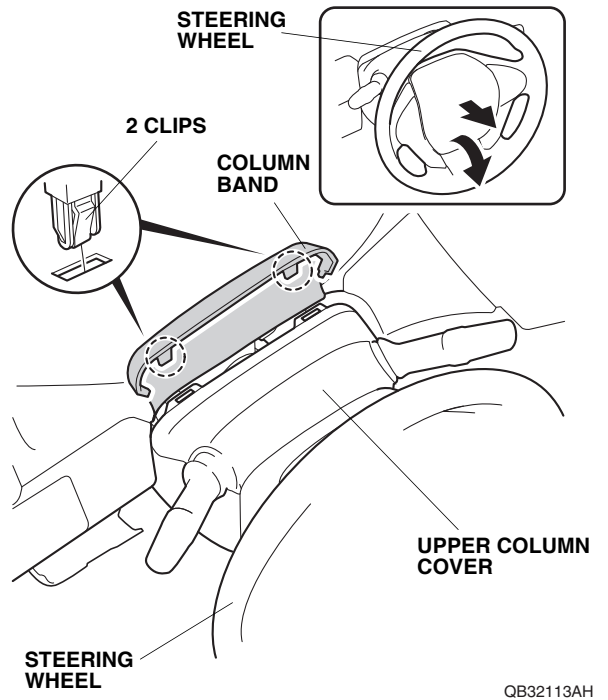

21. Turn the steering wheel 60° clockwise. Using a plastic trim tool, release the retaining tab.

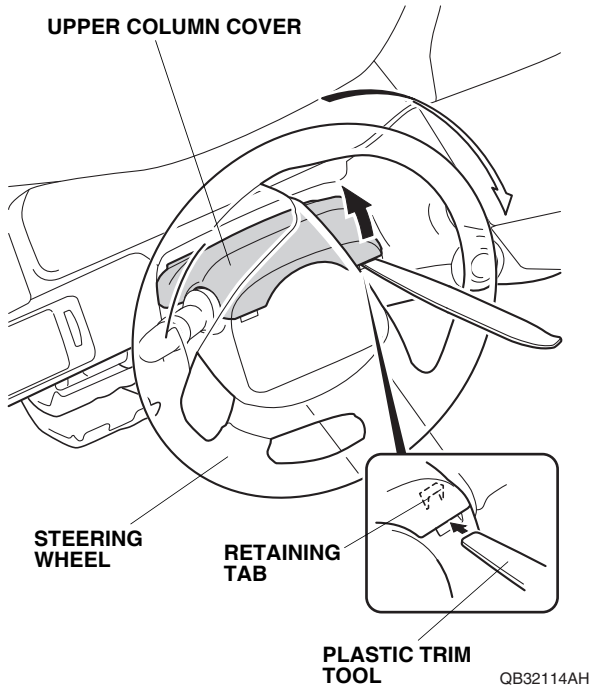

22. Turn the steering wheel 120° counterclockwise. Using a plastic trim tool, release the retaining tab.

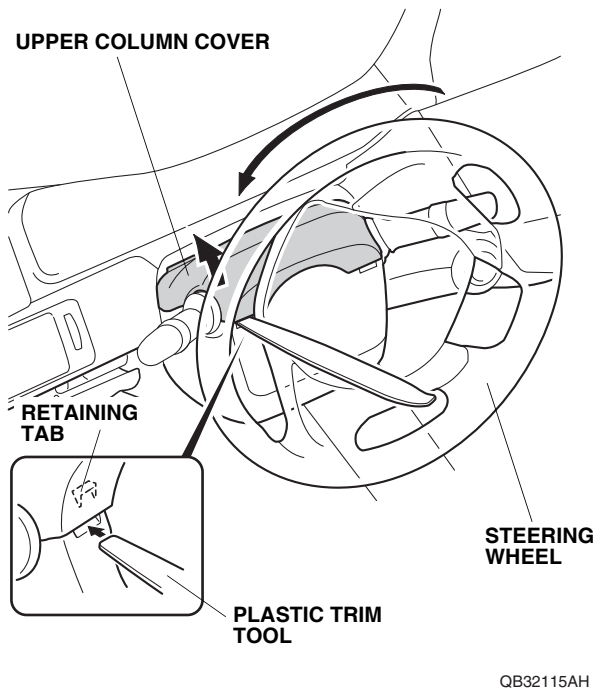

23. Remove the upper column cover (two retaining tabs and two hooks).

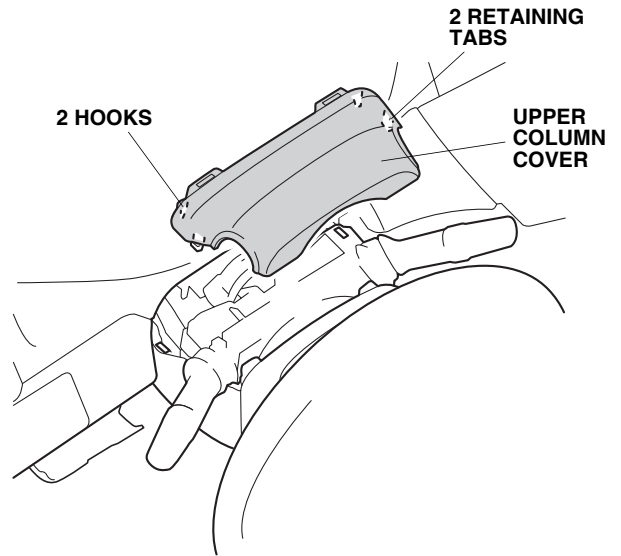

QB32116AH

24. Remove one self-tapping screw from the lower column cover.

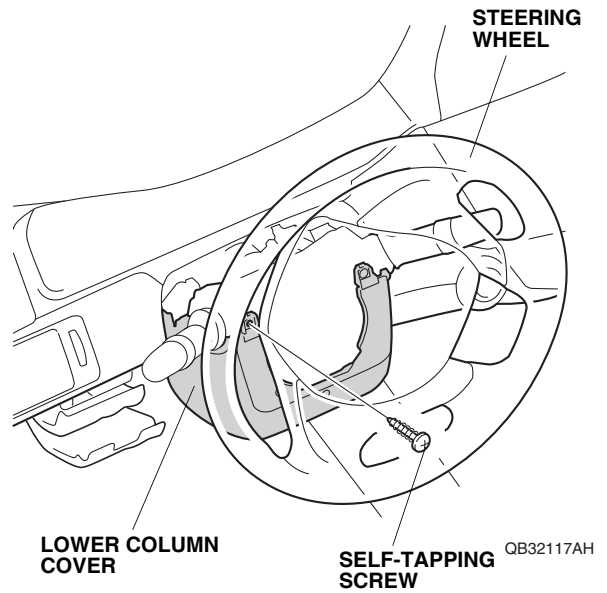

25. Turn the steering wheel 120° clockwise, and remove the other self-tapping screw from the lower column cover.

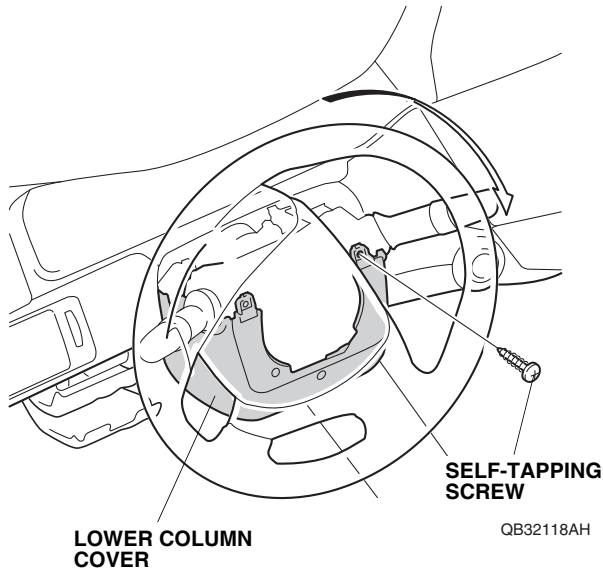

26. Remove the lower column cover (one self-tapping screw).

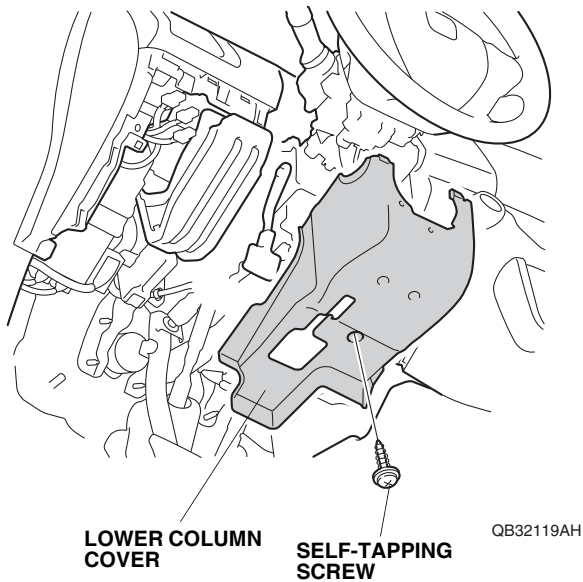

27. Press the power switch to select the OFF mode. Disconnect the negative cable from the battery.

Installing the Antenna

28. Using scissors, cut one urethane tape in half. Wrap two halves of urethane tape to the antenna cable as shown.

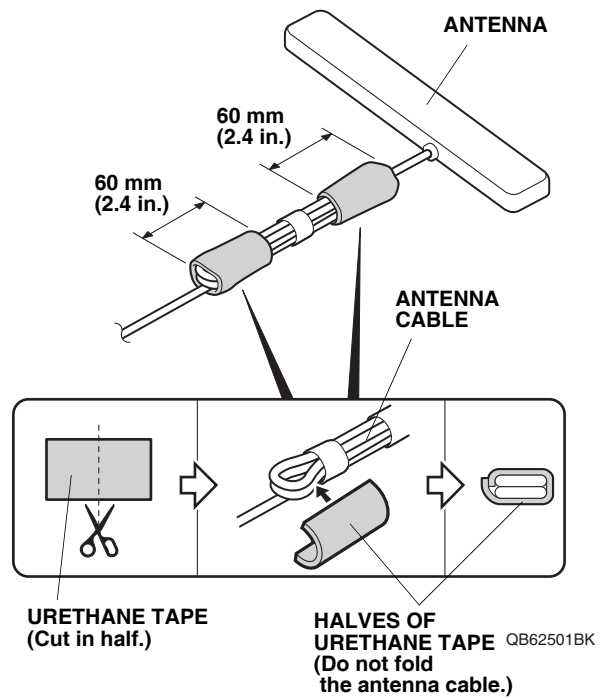

29. Starting near the antenna end of the cable, wrap one urethane tape around the antenna cable at the measurements shown.

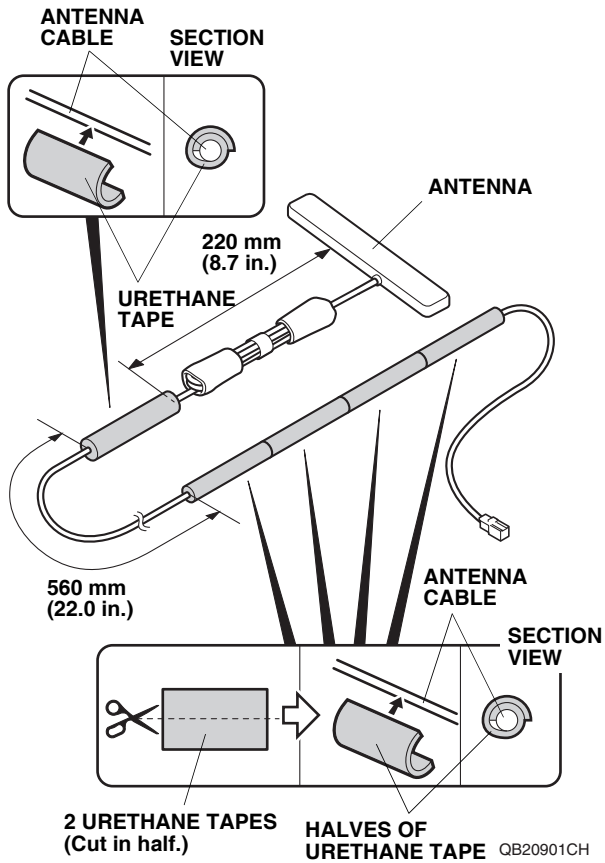

30. Using scissors, cut two urethane tapes in half. Wrap four halves of urethane tape around the antenna cable at the measurements shown.

31. Attach the antenna.
- Attach masking tape to the windshield at the measurement shown.

With Camera Cover

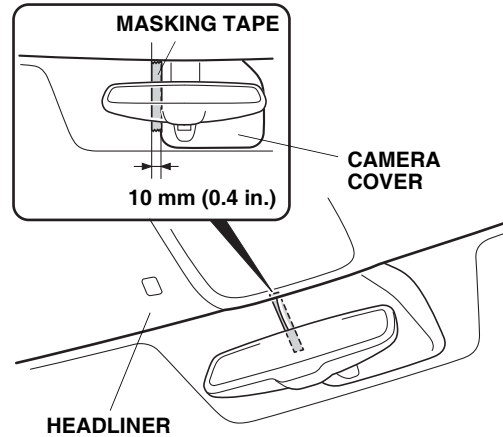

QB51403BH

Without Camera Cover

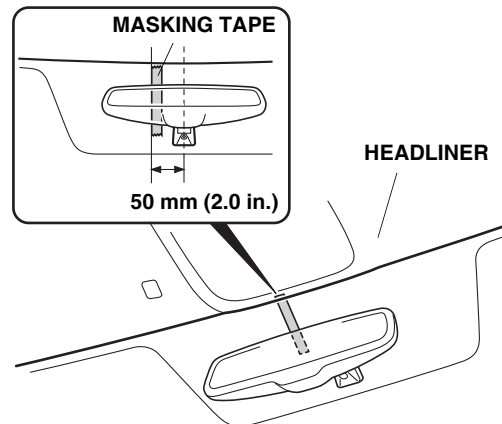

QB51402BH

- Fold the adhesive backing of the antenna as shown.

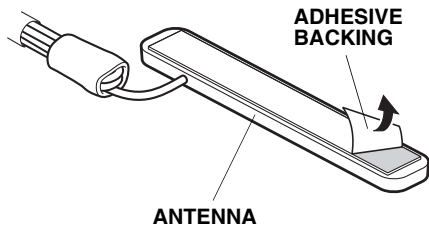

QB51401CH

- Using isopropyl alcohol on a shop towel, clean the windshield where the antenna will attach.
- Attach the antenna with masking tape. Adjust the position of the antenna so there is equal spacing on both sides.

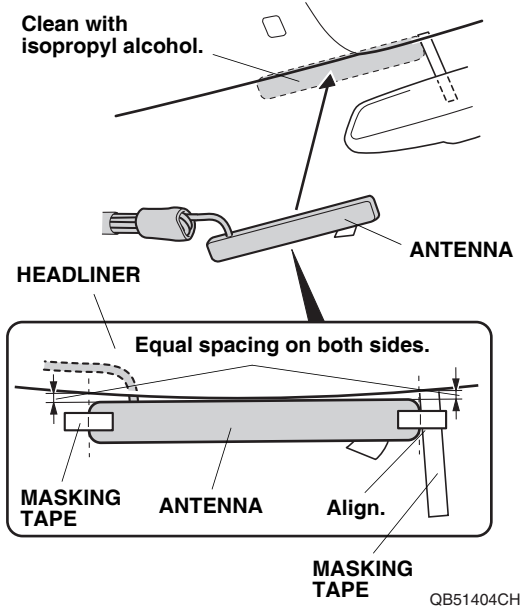

- Carefully remove the adhesive backing from the antenna, and attach the antenna to the windshield. Press and hold the antenna firmly in place for 30 seconds.
- Remove the masking tape.

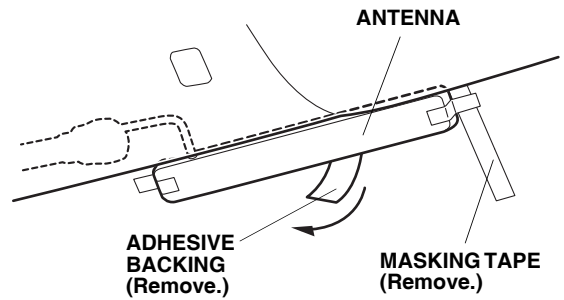

QB51405CH

32. Gently pull down the headliner, and tuck the antenna cable under the headliner. Be careful not to crease the headliner.

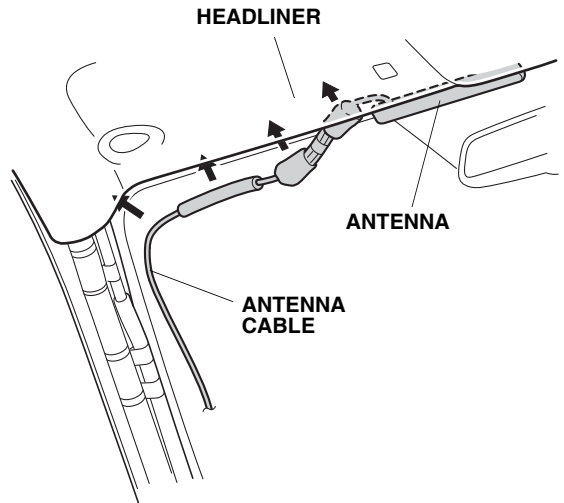

QB20904CH

33. Route the antenna cable down the driver's A-pillar as shown. Using five wire ties, secure the antenna cable to the vehicle harness.

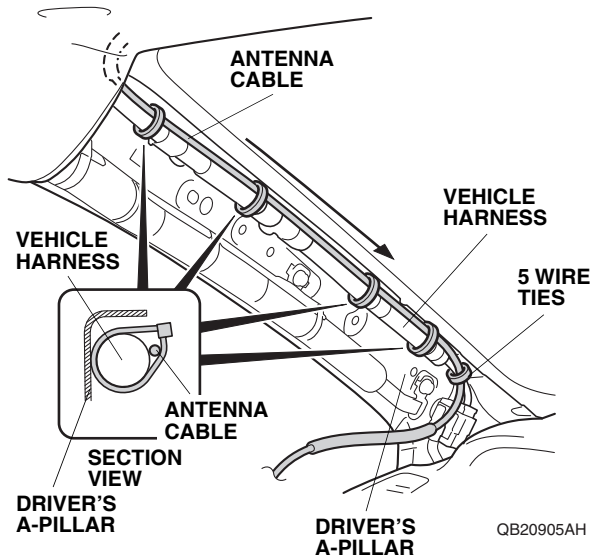

34. Pull away the door opening seal. Route the antenna cable down next to the dashboard, and tuck the antenna cable between the driver's A-pillar and the dashboard. Reinstall the door opening seal.

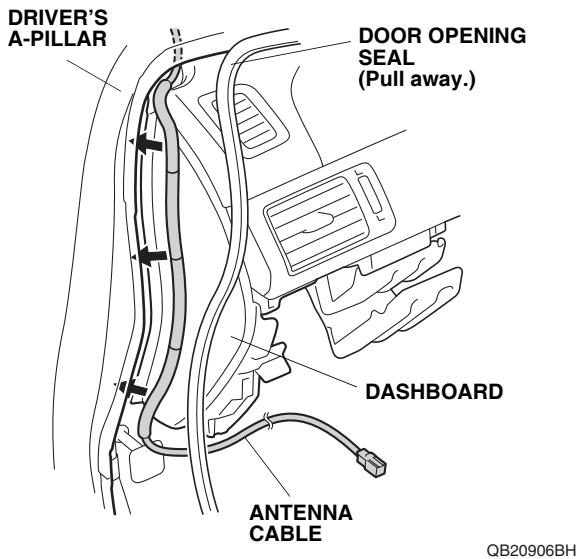

Routing the Engine Starter Harness

35. Using isopropyl alcohol on a shop towel, clean the areas where the fuse labels will attach.

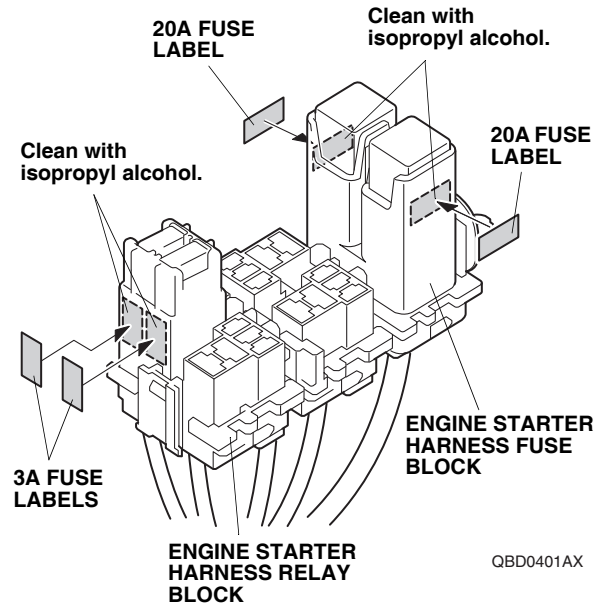

36. Attach two 3A fuse labels to the engine starter harness relay block.
37. Attach two 20A fuse labels to the engine starter harness fuse block.
38. Install three relays to the engine starter harness relay blocks.

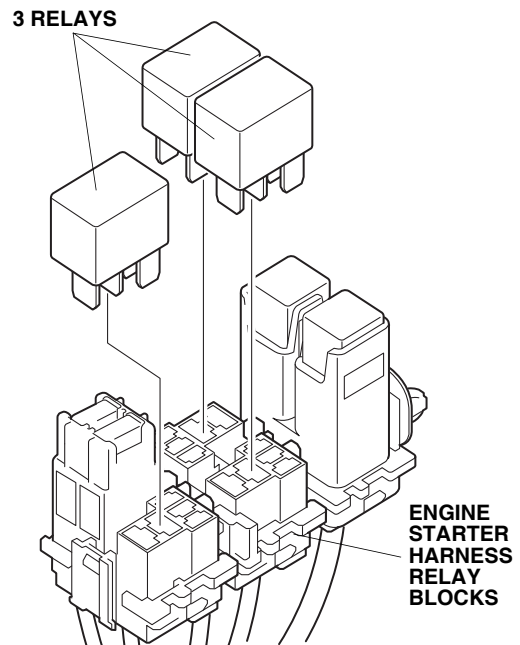

39. Using scissors, cut one urethane tape to the measurement shown. Attach the cut urethane tape to the engine starter harness relay blocks and engine starter harness fuse block as shown.

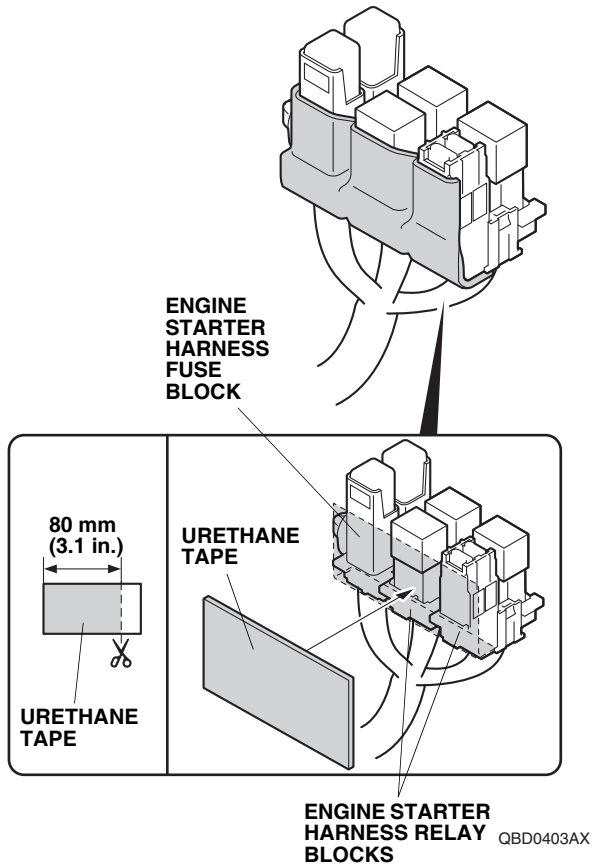

40. Using scissors, cut one urethane tape to the measurements shown. Wrap the cut urethane tape around the engine starter harness 5-pin connector.

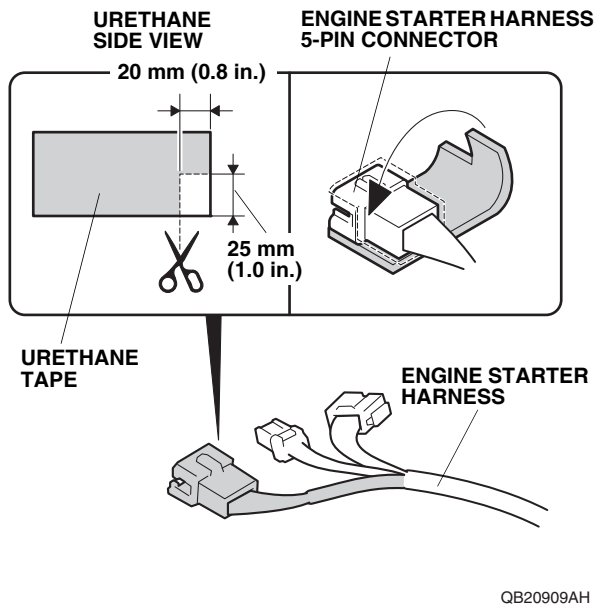

41. Unplug the vehicle 5-pin connector from the fuse box. Plug the engine starter harness 5-pin connector into the fuse box 5-pin connector. Plug the vehicle 5-pin connector into the engine starter harness 5-pin connector.

NOTICE: Make sure the engine starter harness 5-pin connector is securely connected to the fuse box 5-pin connector. A loose connection can cause the engine to stall during driving.

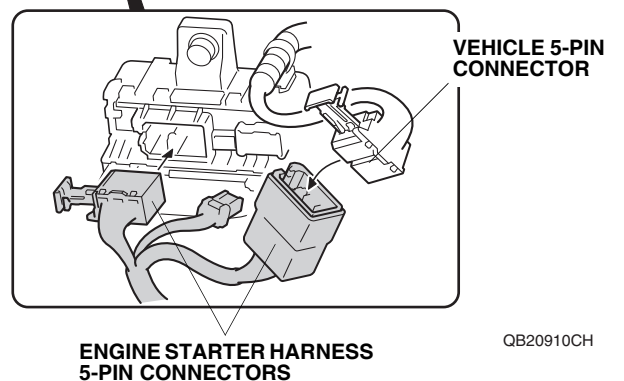
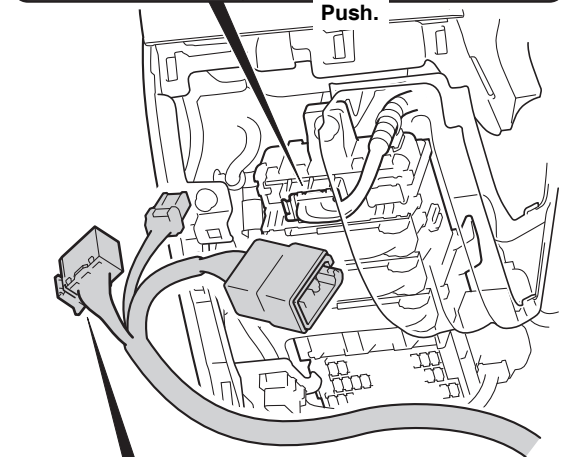
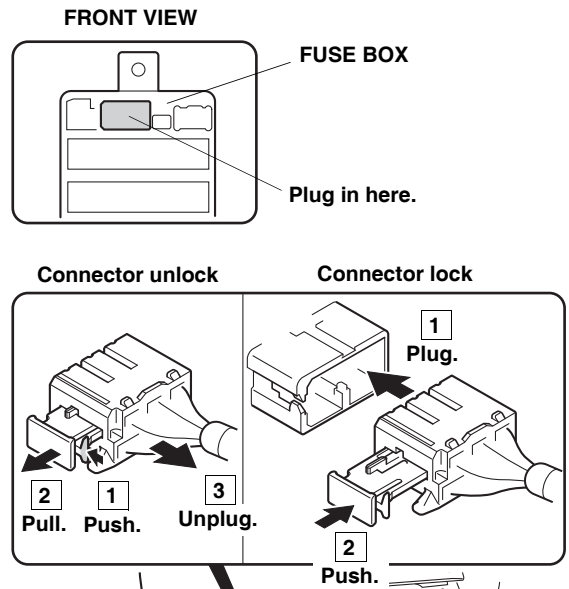

QB20910CH

42. Using two wire ties, secure the engine starter harness to the vehicle harness.

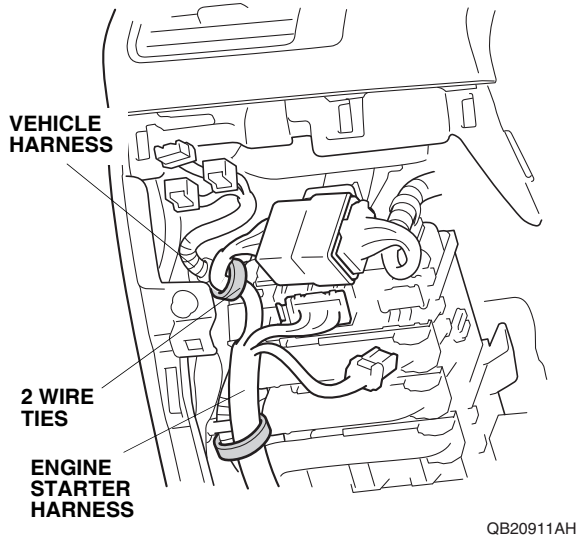

43. Plug the engine starter harness 4-pin connector into the fuse box.

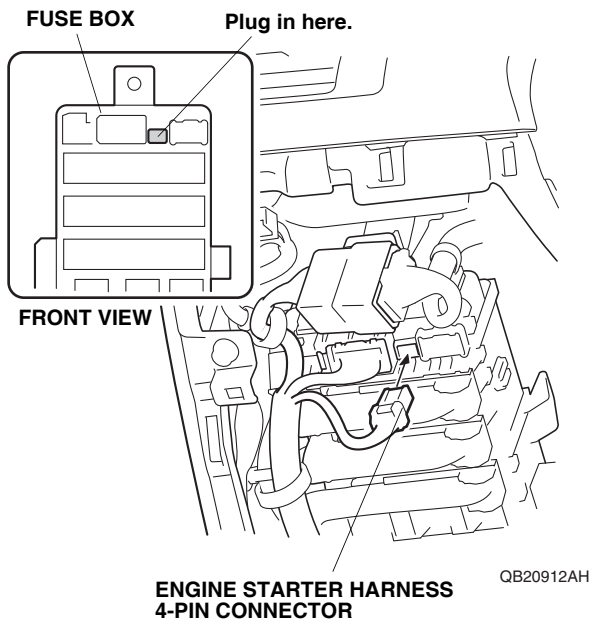

44. Route the engine starter harness as shown.

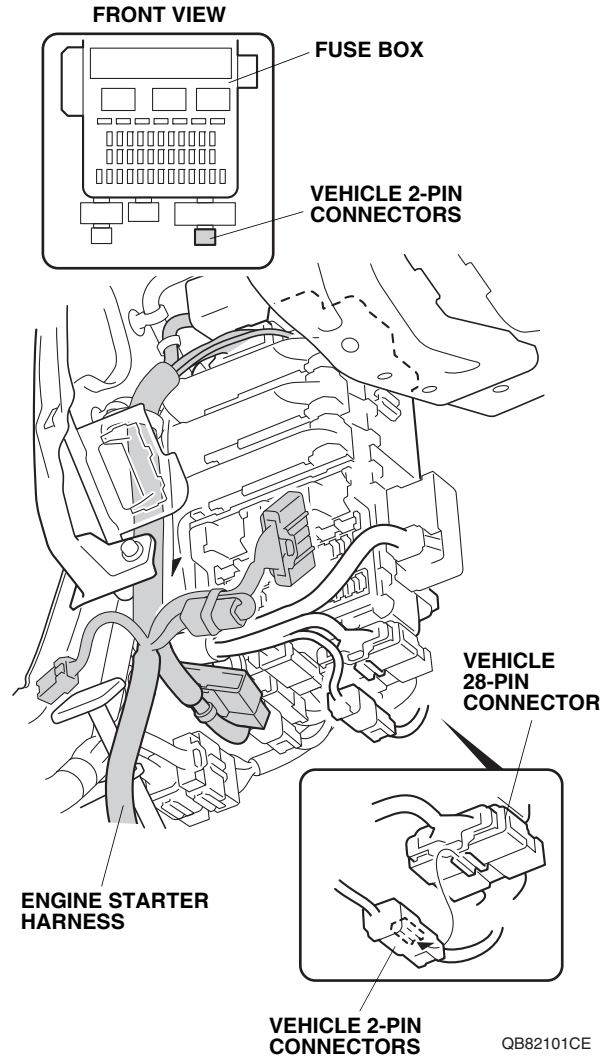

45. Release the vehicle 2-pin connectors.

46. Install the engine starter harness 28-pin connector to the vehicle 28-pin connector.

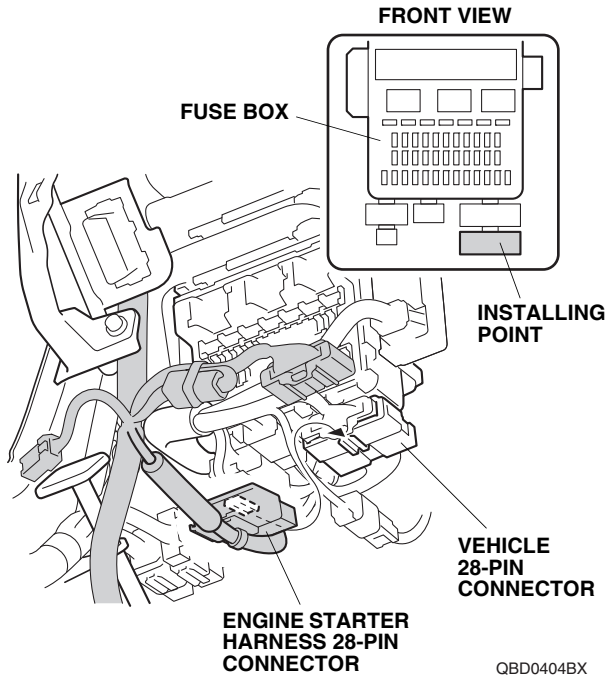

47. Unplug the vehicle 28-pin connector, and plug it into the engine starter harness 28-pin connector. Plug the engine starter harness 28-pin connector into the vehicle 28-pin connector.

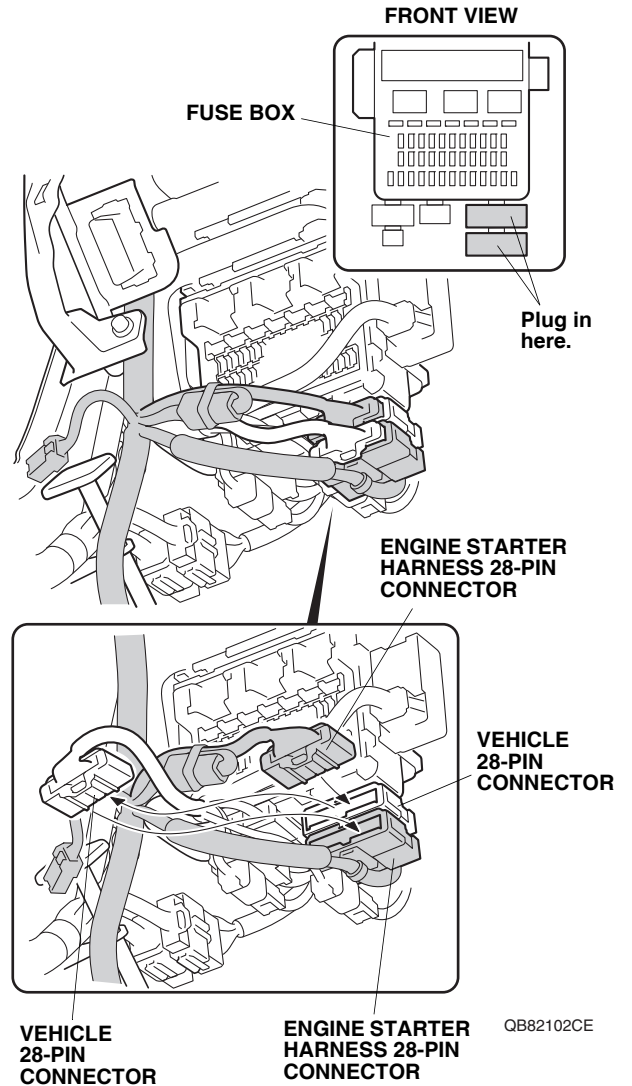

48. Install the vehicle 2-pin connectors.

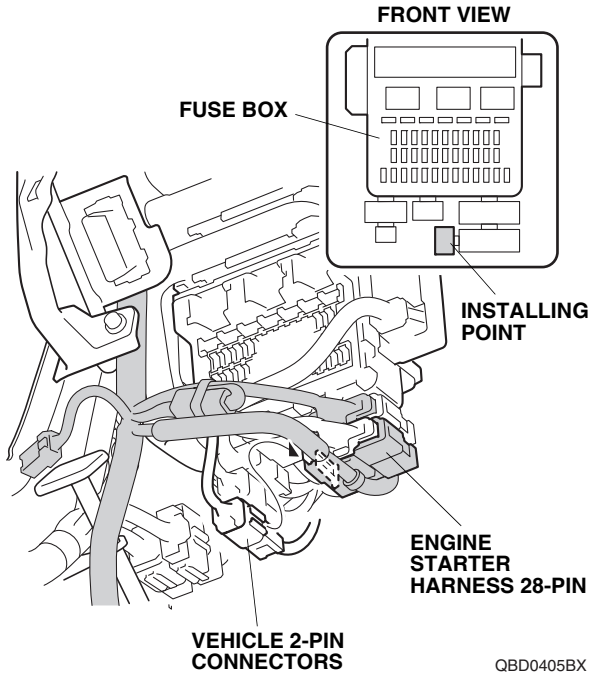

49. Unplug the vehicle 2-pin connector, and plug it into the engine starter harness 2-pin connector. Plug the engine starter harness 2-pin connector into the vehicle 2-pin connector.

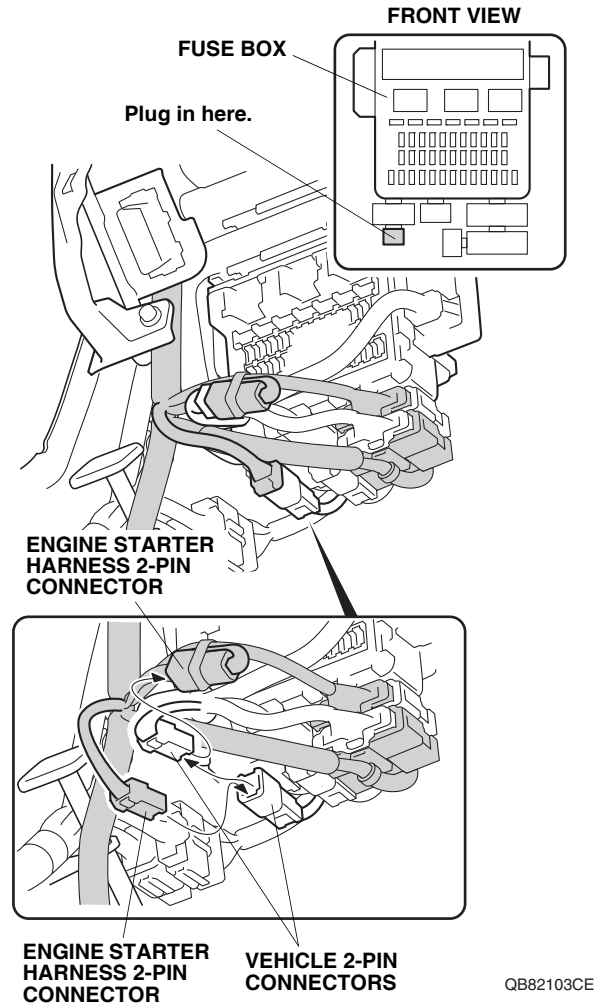

50. Install the control unit bracket to the control unit.

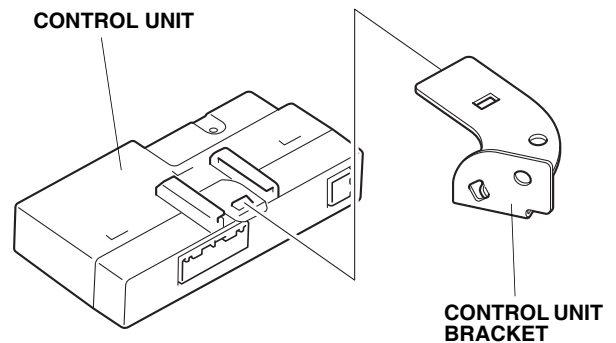

QB82104AE

51. Using isopropyl alcohol on a shop towel, clean the control unit where the urethane tape will attach.

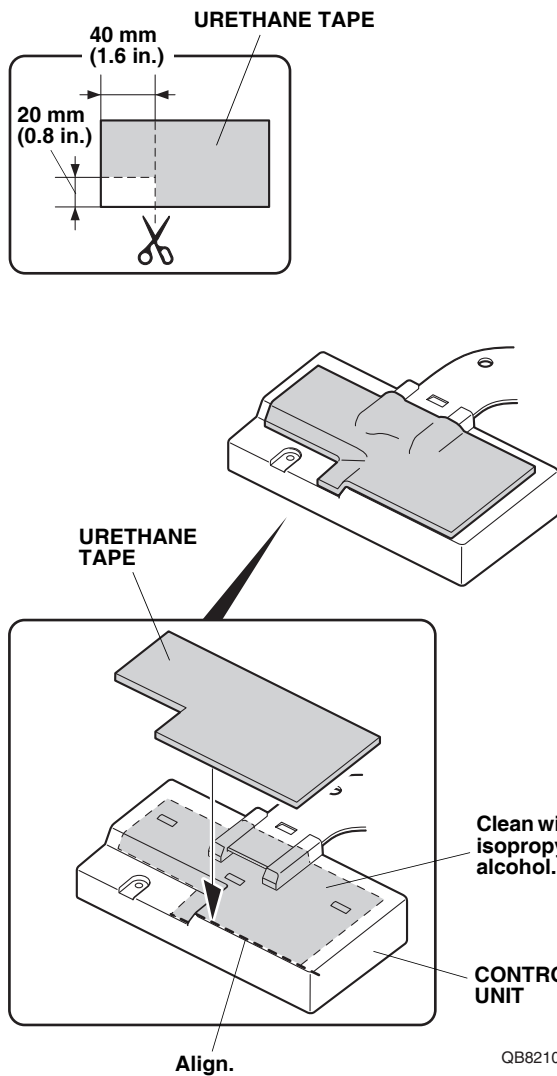

52. Using scissors, cut one urethane tape to the measurements shown. Attach the cut urethane tape to the control unit as shown.

53. Plug the antenna cable connector and engine starter harness 28-pin connector into the control unit.

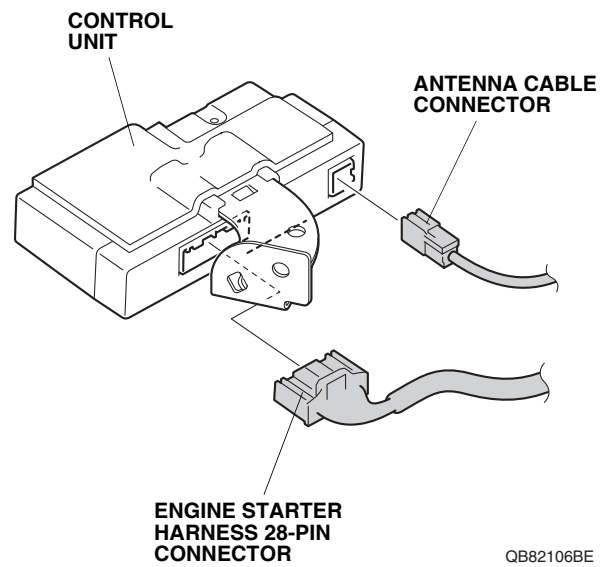

54. Install the engine starter harness clip to the control unit bracket.

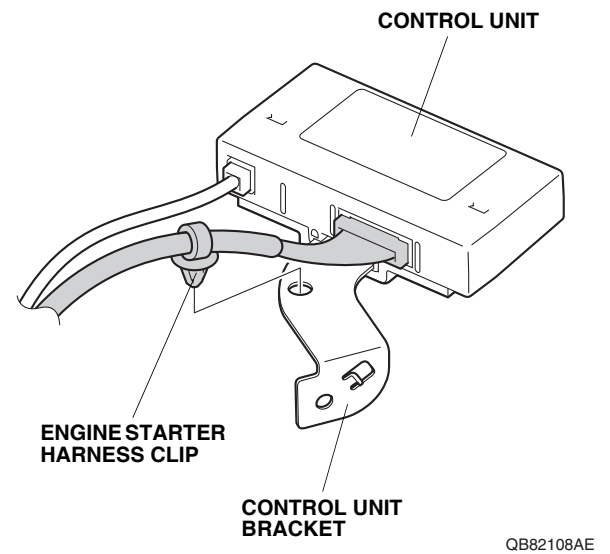

55. Using one 6 mm flange nut, secure the control unit bracket to the vehicle bolt as shown.

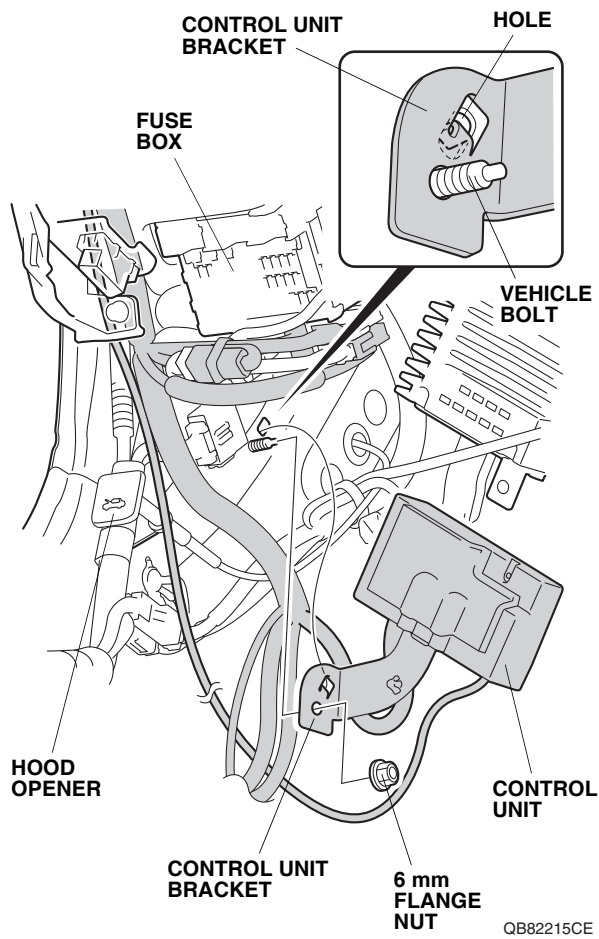

56. Remove the cap from the vehicle bolt.

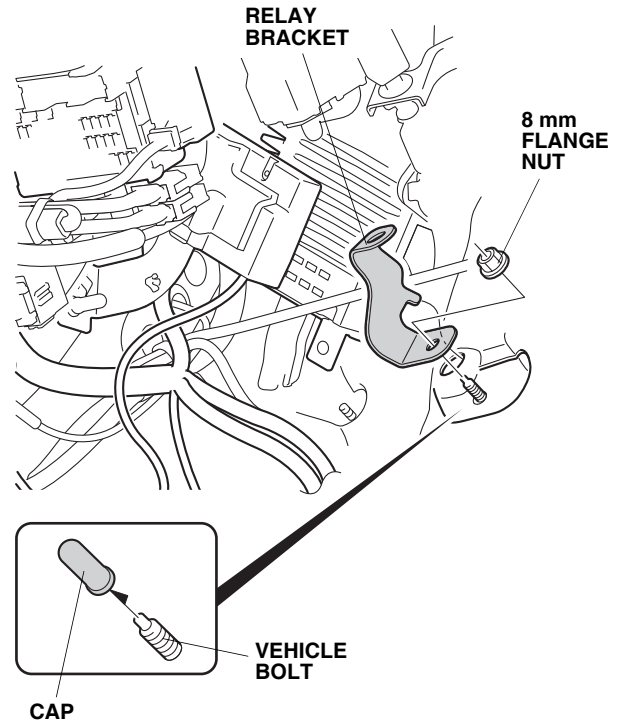

57. Using one 8 mm flange nut, secure the relay bracket to the vehicle bolt as shown.

58. Using isopropyl alcohol on a shop towel, clean the relay bracket where the urethane tape will attach.

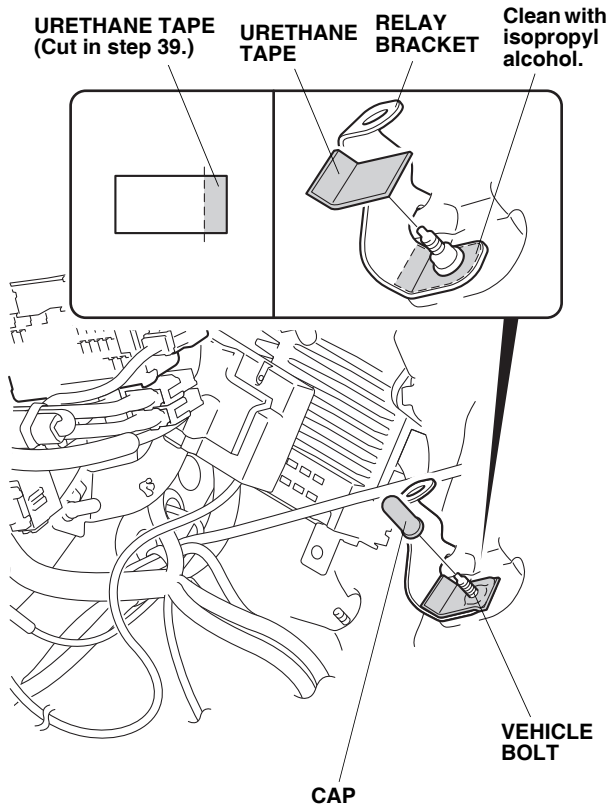

QBD2701BG

59. Attach the remaining piece of urethane tape (cut in step 39) to the relay bracket.
60. Reinstall the cap.

61. Install the engine starter harness relay blocks to the relay bracket.

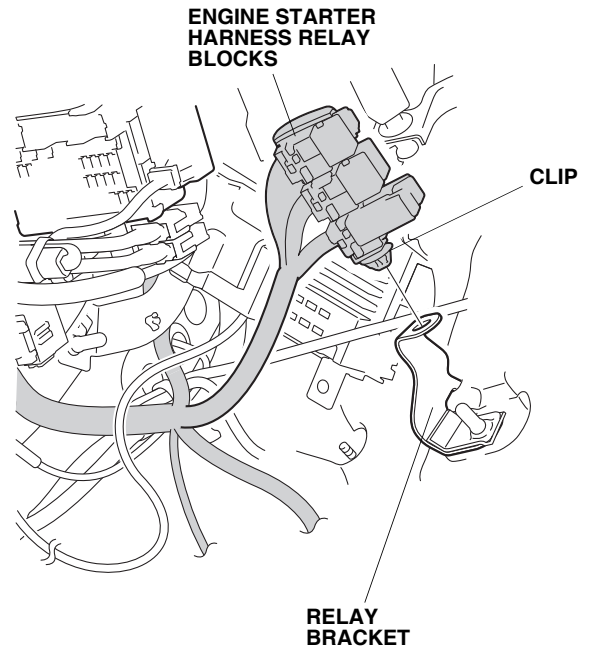

QB82217CE

62. If the vehicle is equipped with the vehicle unit, secure the engine starter harness to the vehicle bracket using one wire tie.

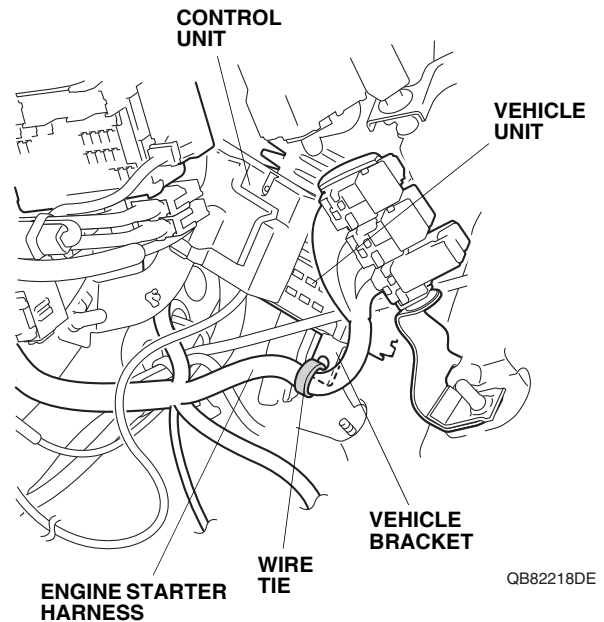

QB82218DE

63. Remove the vehicle ground bolt.

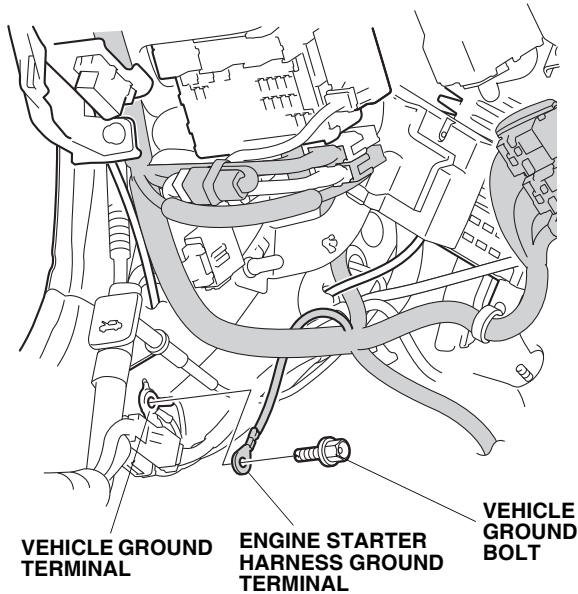

QB82219CE

64. Install the engine starter harness ground terminal to the vehicle ground terminal, and reinstall the vehicle ground bolt.
65. Secure the antenna cable and engine starter harness to the vehicle harness using one wire tie.

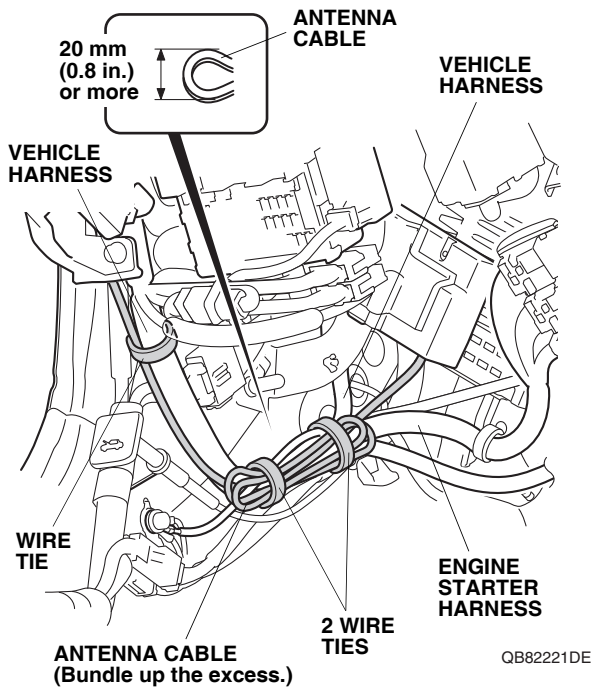

QB82221DE

66. Bundle up the excess antenna cable as shown. Using two wire ties, secure the antenna cable and engine starter harness to the vehicle harness.

67. Secure the engine starter harness to the hole in the vehicle frame with one wire tie with clip at the white tape on the engine starter harness.

NOTE: If another accessory harness is already attached, align the white tape on the engine starter harness with the clip on the other harness. Using one wire tie with clip, secure the engine starter harness to the other accessory harness.

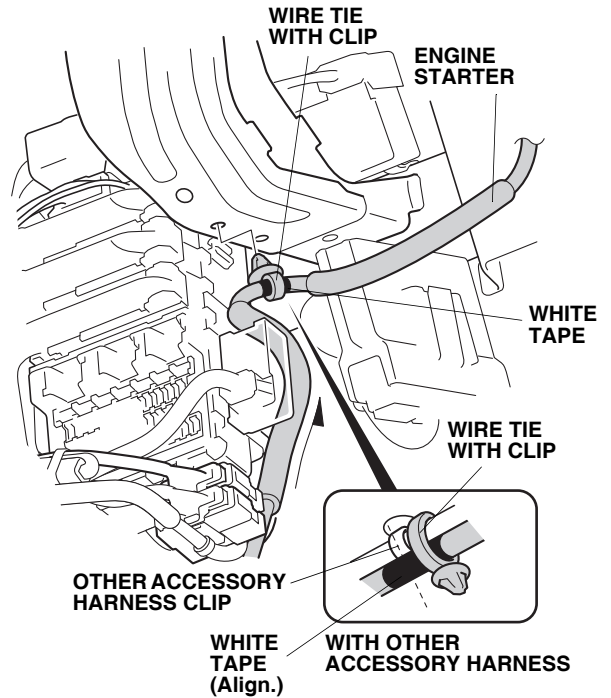

QB82222BE

68. Route the 12-pin/10-pin connector ends of the engine starter harness as shown.

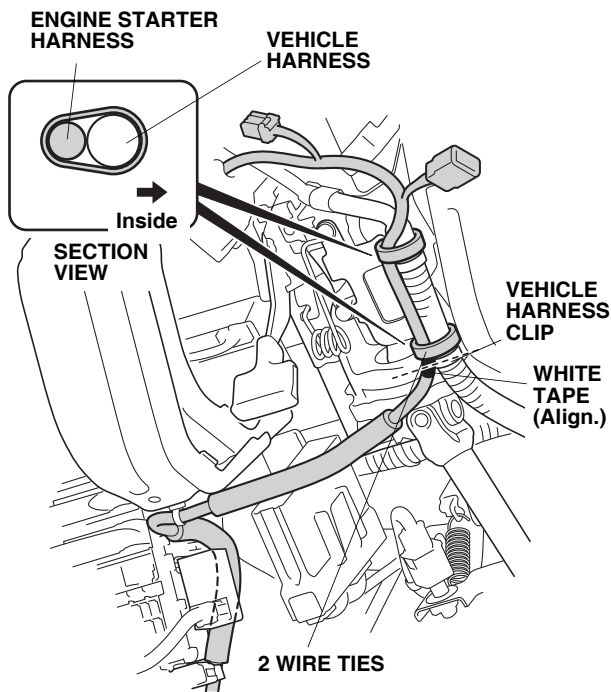

QB20933AH

69. Align the white tape on the engine starter harness with the clip on the vehicle harness, and secure the engine starter harness to the vehicle harness using one wire tie.
70. Using one wire tie, secure the engine starter harness to the vehicle harness.

71. Route the engine starter harness as shown. Unplug the vehicle 10-pin connector, and plug it into the engine starter harness 10-pin connector. Plug the remaining engine starter harness 10-pin connector into the wiper switch.

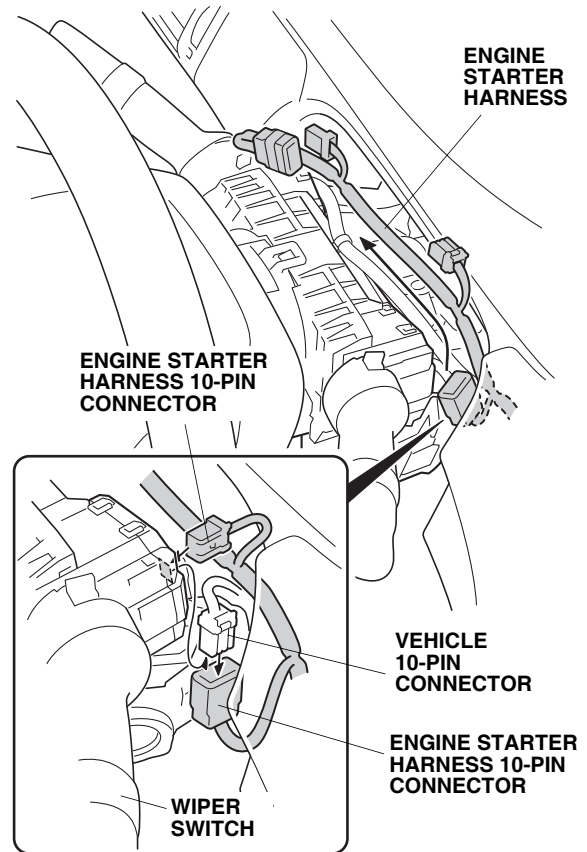

QB20934AH

72. Using one wire tie, secure the 10-pin connector and the engine starter harness to the vehicle harness.

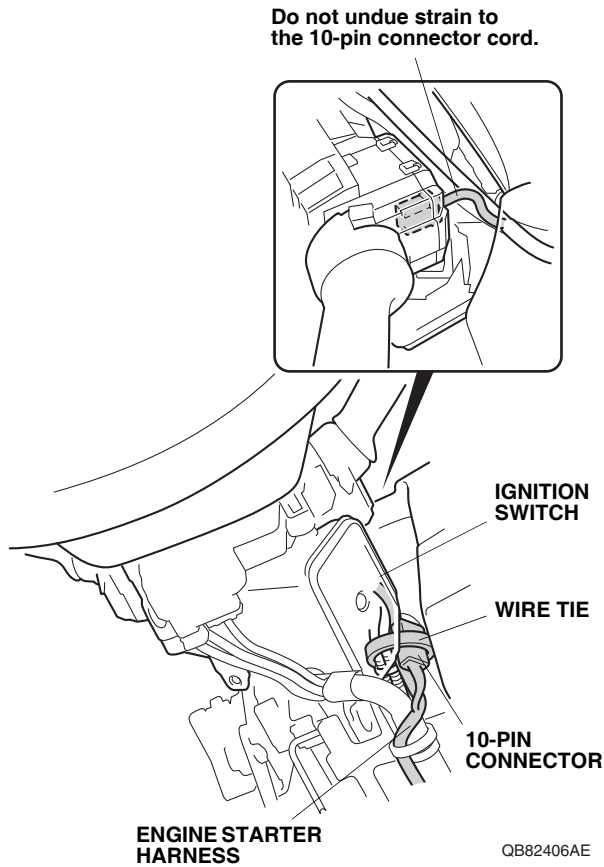

73. Route the engine starter harness as shown. Unplug the vehicle 12-pin connector, and plug it into the engine starter harness 12-pin connector. Plug the remaining engine starter harness 12-pin connector into the combination light switch.

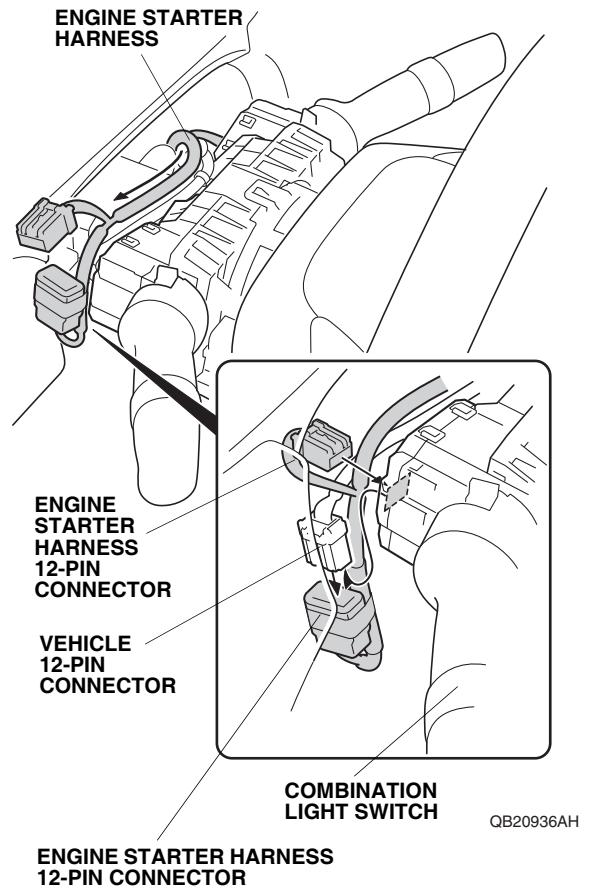

74. Using three wire ties, secure the engine starter harness to the vehicle harness. Do not secure it to the SRS harness.
NOTE: Make sure that the connectors and harness are not pinched, or are not interfering with the steering wheel when it is moved for adjustment.

Do not undue strain to the 12-pin connector cord.

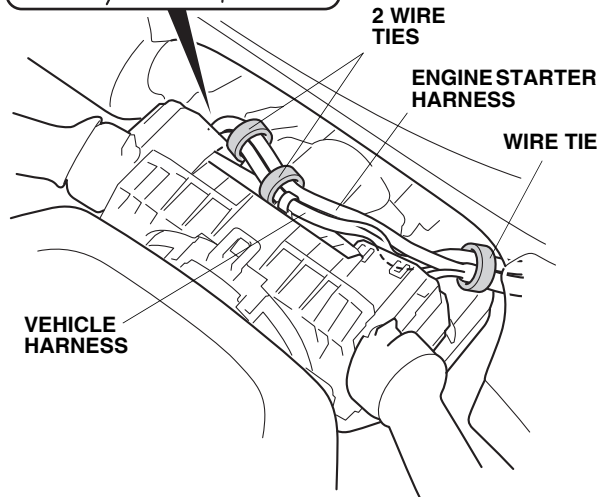
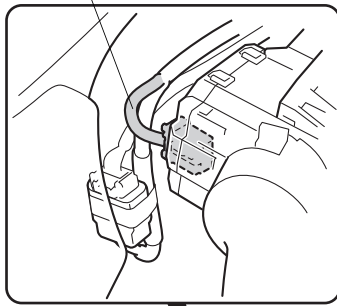

QB82407AE

75. Using isopropyl alcohol on a shop towel, thoroughly clean the hood where the caution label will attach.

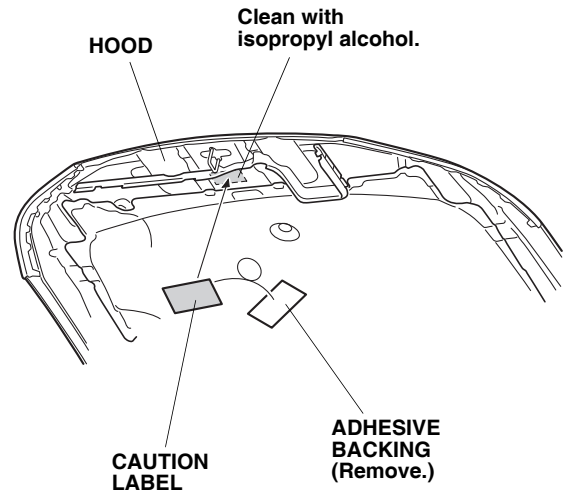

QBD2702AG

76. Remove the adhesive backing from the caution label, and attach the caution label to the hood in the area shown.
77. Check that all wire harnesses are routed properly and all connectors are plugged in.
78. Reinstall all removed parts.
79. Reconnect the negative cable to the battery.
80. Check the operation of the headlights and wipers.
81. Press and hold the radio power button for two seconds to restore the radio and navi (if equipped) system functions.
82. Reset the clock on vehicle without navigation.
83. Perform the "REMOTE ENGINE STARTER REGISTRATION" and the "Check the operation of the Remote Control Engine Starter."

REMOTE ENGINE STARTER REGISTRATION

NOTE: Register after making sure the HDS has been upgraded to the latest version as described in the Service News.

1. Acquire the PCM Code from the Interactive Network.

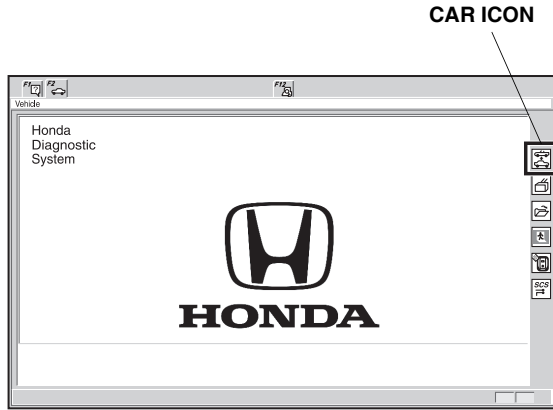

QC31909AC

2. Connect the HDS/MVCI tester to the OBD II data link connector, then press the power switch to the on (II) position.
3. Start the HDS, and click the car icon.
4. Input the VIN and other required information into the HDS, then click the check button.

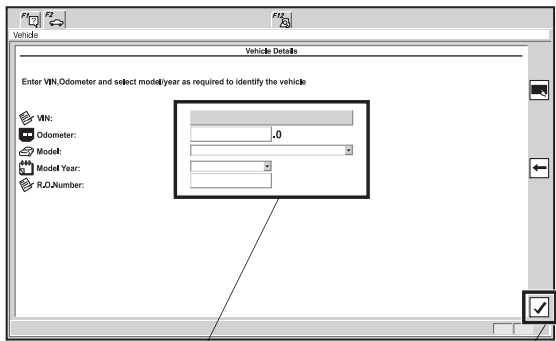

Input the VIN and other required information.

CHECK BUTTON

QB32102BH

5. Select **Honda Systems**, then click the check button.

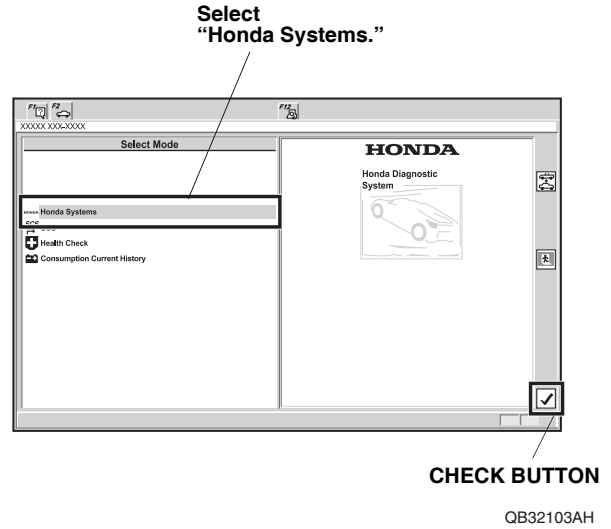

CHECK BUTTON

QB32103AH

6. Select **R/C ENG STARTER** and click the check button.

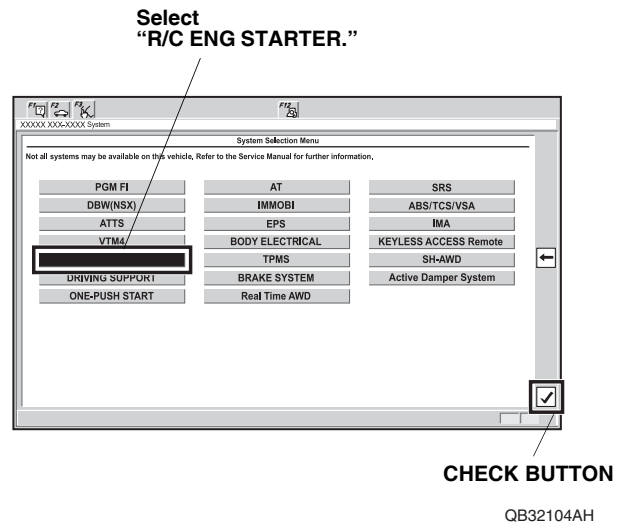

CHECK BUTTON

QB32104AH

- Select **REGISTER REMOTE CONTROL ENGINE STARTER UNIT**, then click the check button.

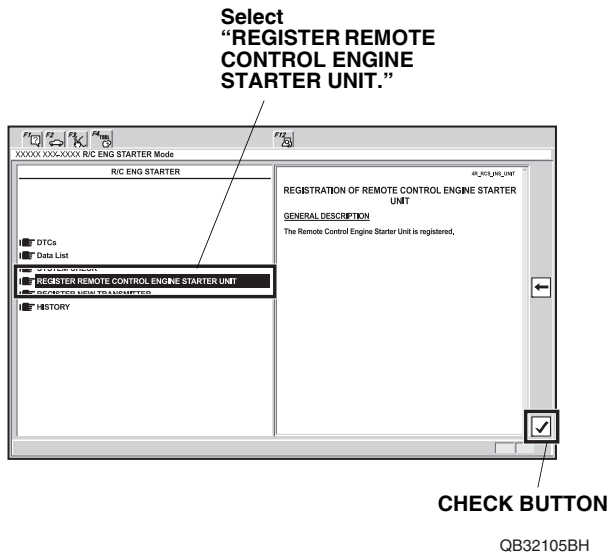

- The following message will display: **Obtain PCM-code (IMMOBILIZER PCM CODE) from iN. This vehicle's VIN will be required to obtain the password. (USA)** Click the check button.

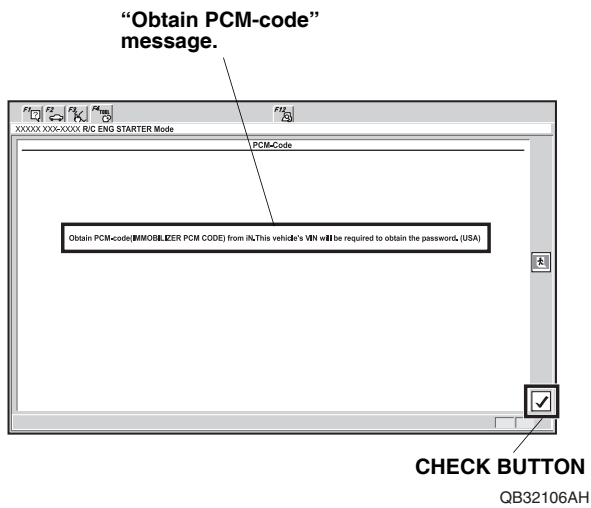

- Input the PCM-code, then click the check button. **NOTE:** To ensure security, the PCM-code (password) is changed everyday, so it is impossible to register the remote control engine starter if the dates of the PCM-code acquisition and registration are different. The date of the HDS/MVCI tester should also be the same.

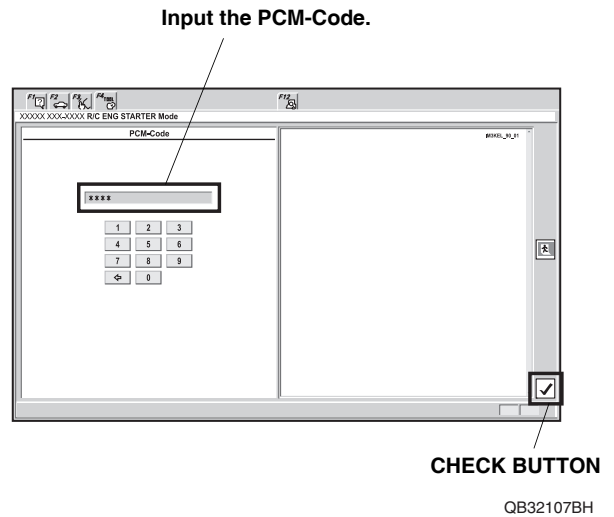

- The following message will display: **The registration of the Remote Control Engine Starter Unit has been completed.** Press the power switch off.

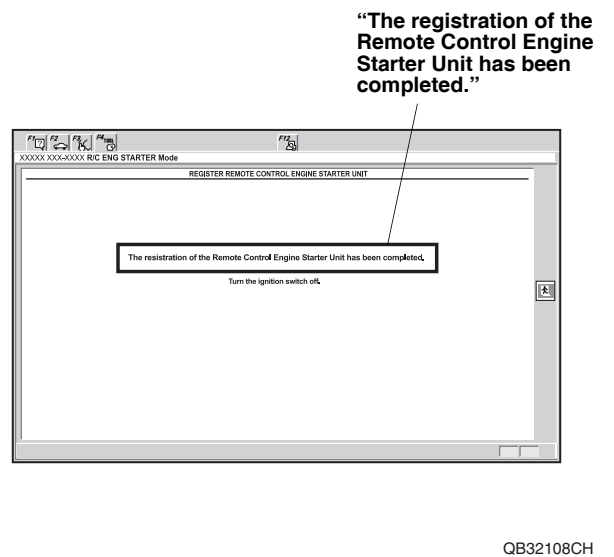

11. The following message will display: **Check that engine can be started by the Transmitter.** Click the check button.

“Check that engine can be started by the Transmitter.”

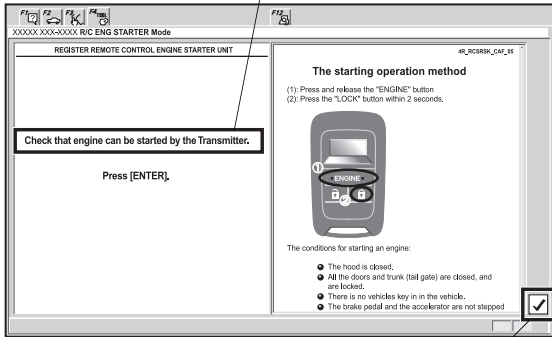

CHECK BUTTON QB32109CH

12. Perform the “Check the operation of the Remote Control Engine Starter” on page 27, then disconnect the HDS/MVCI.

Check the operation of the Remote Control Engine Starter

Operating Conditions

- The hood is closed
- The shift lever is in park
- Turn the power switch off and the key is outside the vehicle
- All doors and trunk lid closed and locked

Inspection

1. Press the engine/command button on the transmitter and release, within 2 seconds, press the lock/start button on the transmitter.

The power system should start if all operating conditions are met.

Does the power system start?

Yes - Operation is normal.
No:
<ul style="list-style-type: none"> • Make sure all "Operating Conditions" are met. • Check the engine starter harness connections. • Connect the HDS/MVCI and check for an indicated failure. (Refer to the appropriate Service Manual for details.)

2. Press the engine/command button on the transmitter and release, within 2 seconds, press the unlock/stop button. The vehicle system should stop.

Does the power system stop?

Yes - Operation is normal.
No - Check the engine starter harness connections.

3. After the power system has stopped, start the vehicle system again, and check that the power system stops after each of the following conditions:

NOTE: After each test the key must be cycled, or the driver's door must be opened and closed.

- Move the shift lever out of the P position.
- Unlock or open the doors or the trunk lid.
- Open the hood.
- Press the power switch.
- Press on the brake pedal.

Does the power system stop after each of these tests?

Yes - Operation is normal.
No - Check the engine starter harness connections.

4. Check that the power windows and the moonroof do not function, and the shift lever does not move to any position when the power system is started with the transmitter.
5. Check that the power system does not start under "Operating Conditions" with the key left inside the vehicle.
6. Start the power system again, press the engine/command button on the transmitter two times, and check the vehicle condition on the display.

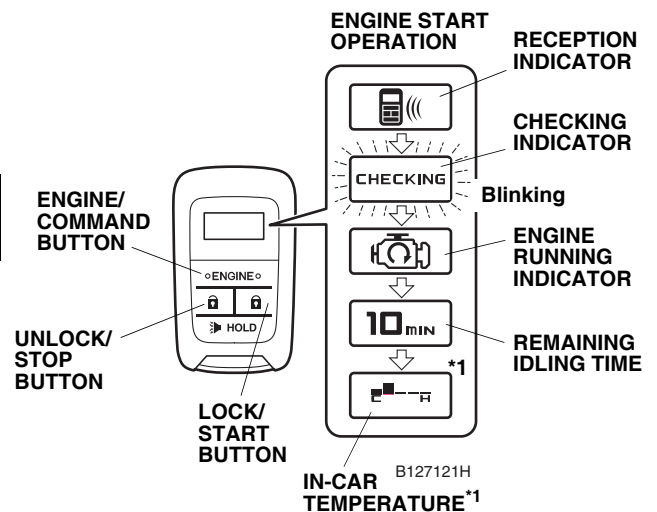

*1 Only on vehicles equipped with the automatic climate control. This indicator is displayed for some vehicles among them.

7. Check the operation of the transmitter when the vehicle is 120 m (400 ft.) away and in direct sight.
8. Press the unlock/stop button on the transmitter and verify that the doors unlock. Press the lock/start button, and verify that the doors lock.
 - For the vehicle equipped with the driving position memory system, make sure to shift the seat position of driver's seat to "Driver 1" by unlock of transmitter.
9. Check that the power system can start by the power switch and that the wiper and the headlight can be operated normally.

